



Ref: SOIL_Ridgers_SERTR_2403_EN

© AVR nv 2024

Stay up-to-date:



2, 4 reihige oder klappbare Maschinen

- 4 reihig



- klappbar

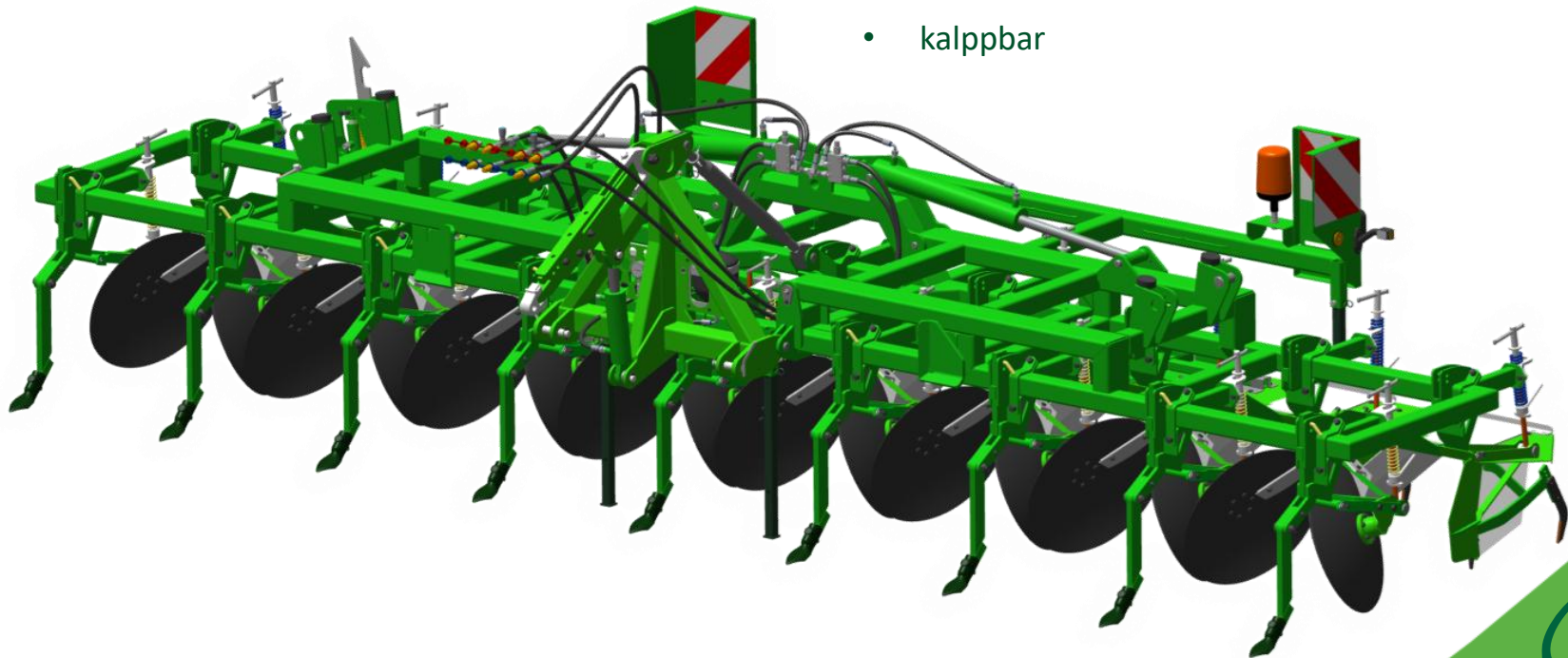

Wie wird der Kombi-Maschine an den Schlepper angehängt?

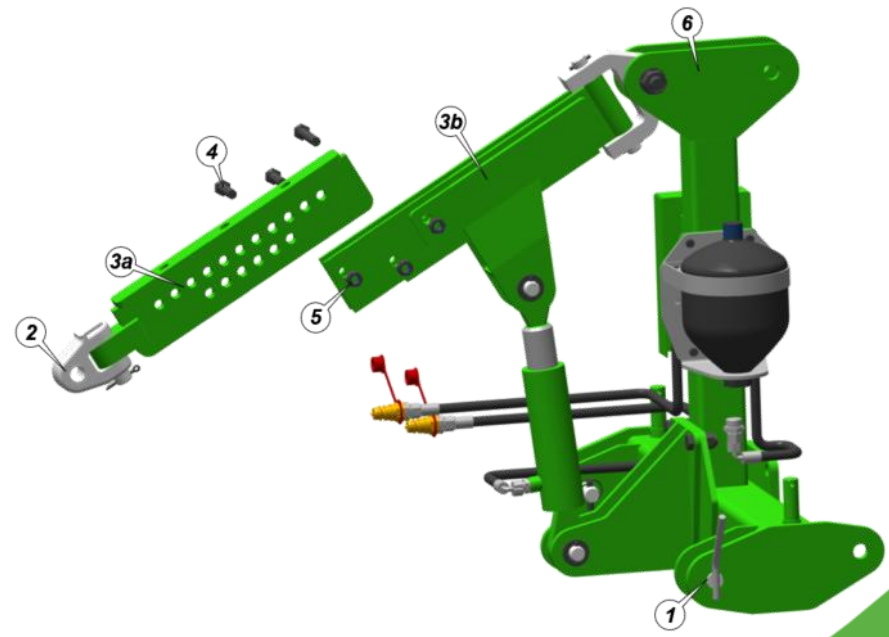
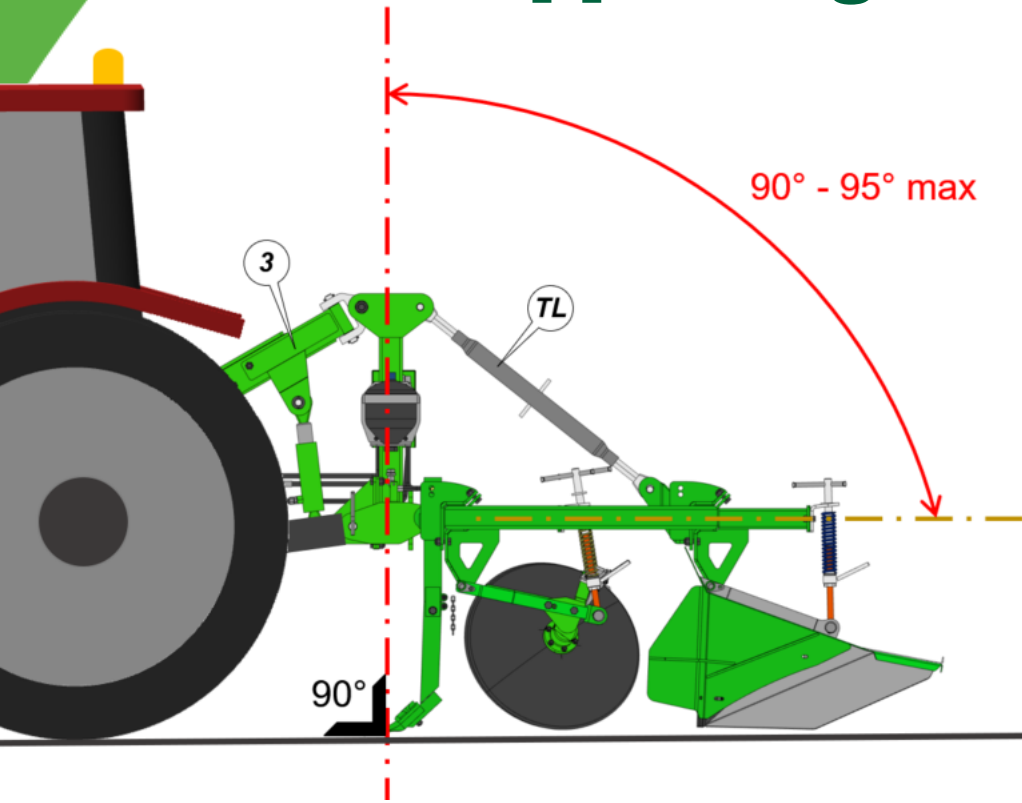

Druckübertragungssystem am Oberlenker

2 oder 4 reihig

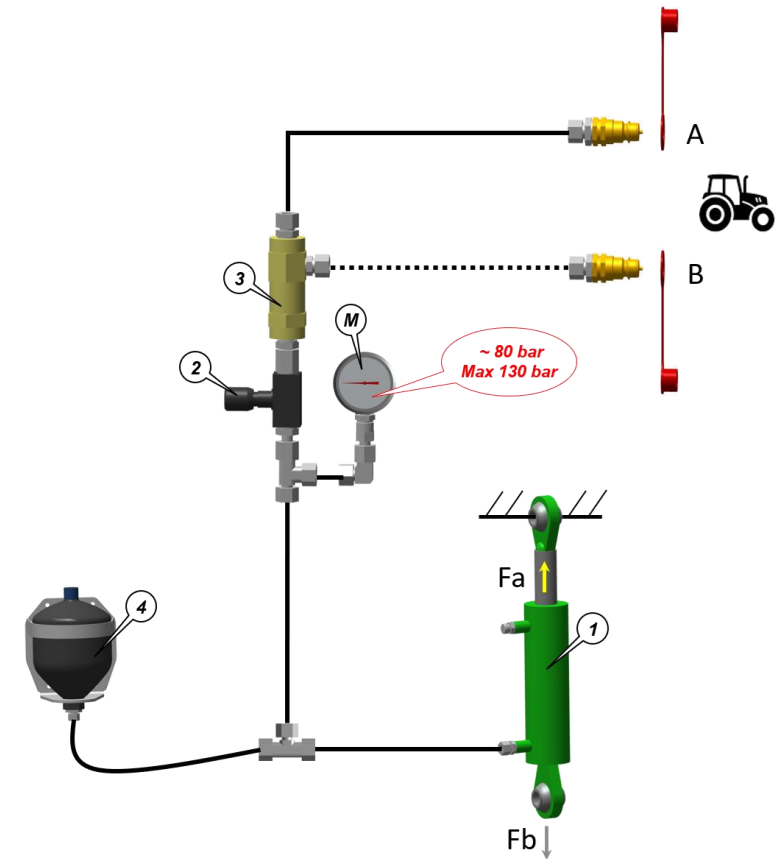
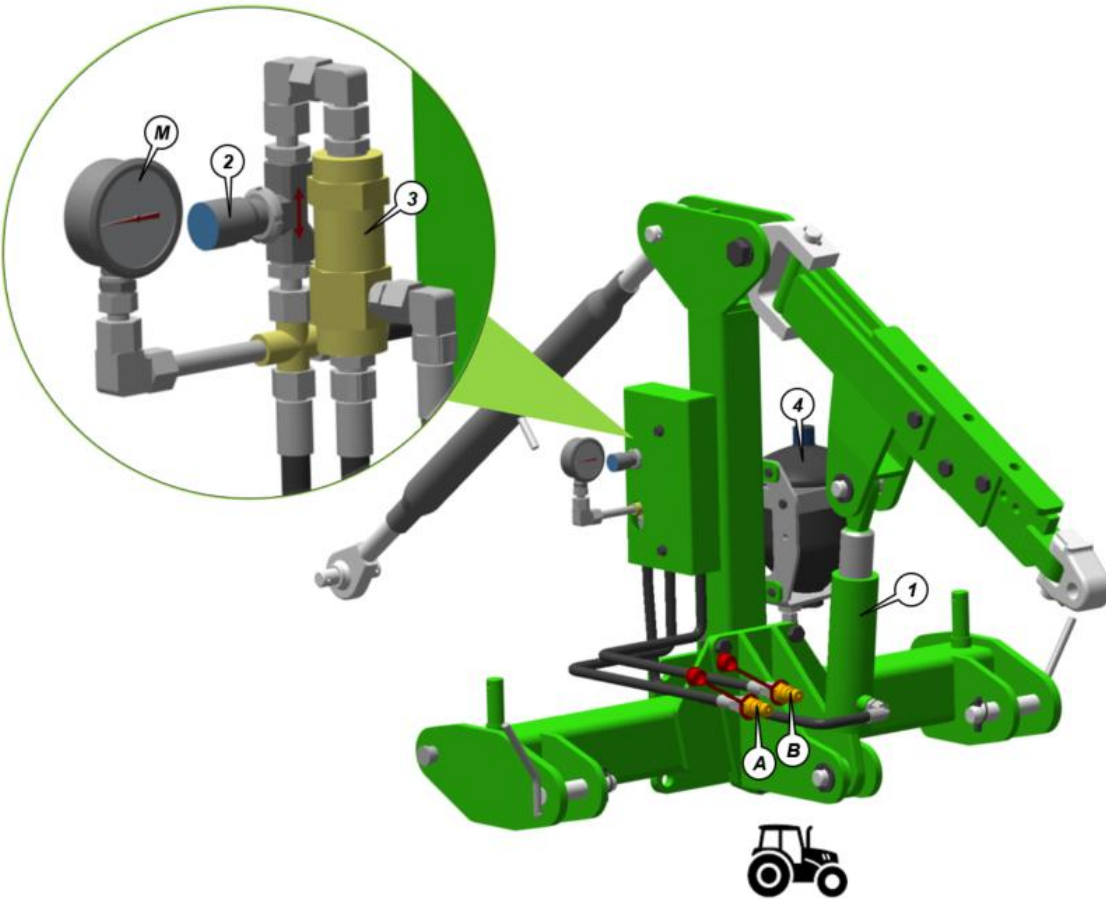

Druckübertragungssystem am Oberlenker

klappbarer Ridger

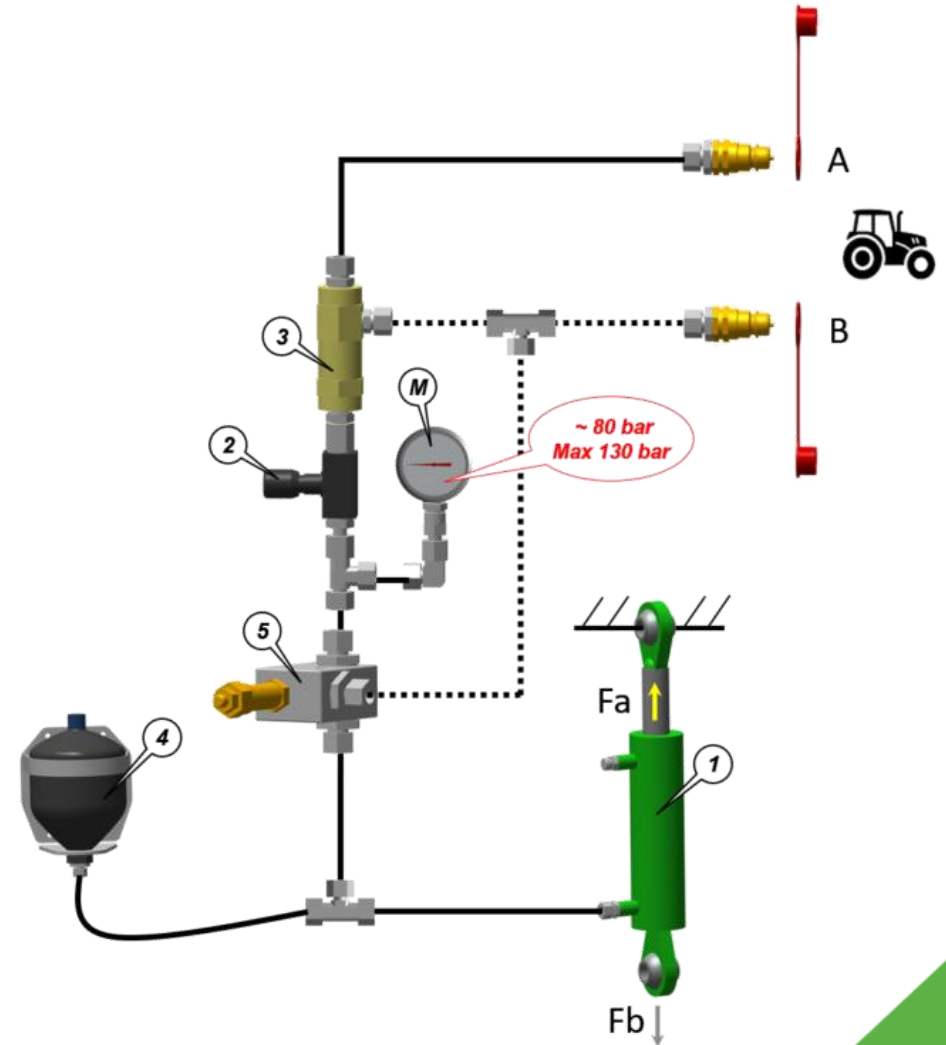

Transport / Arbeitsposition

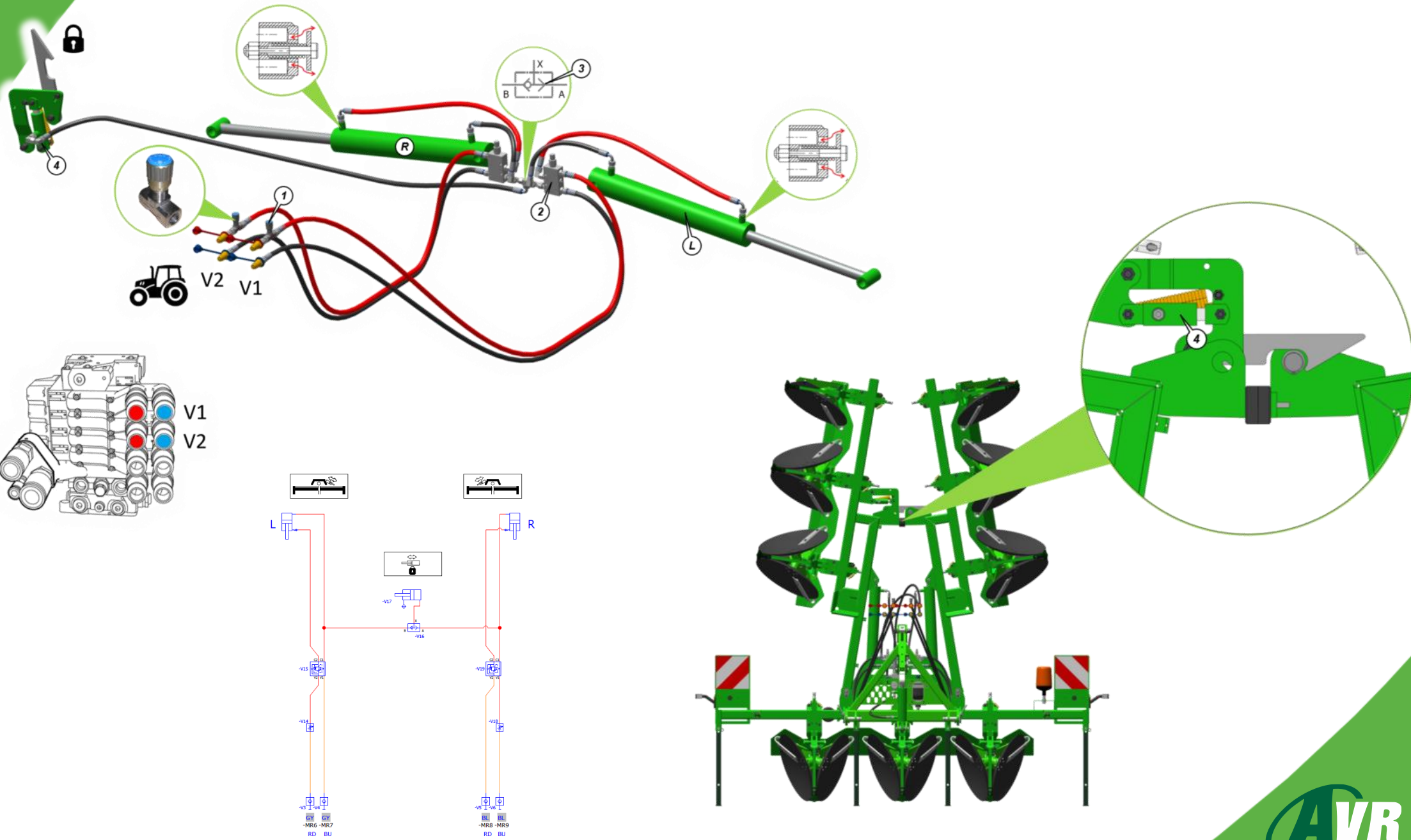

Horizontale Endposition

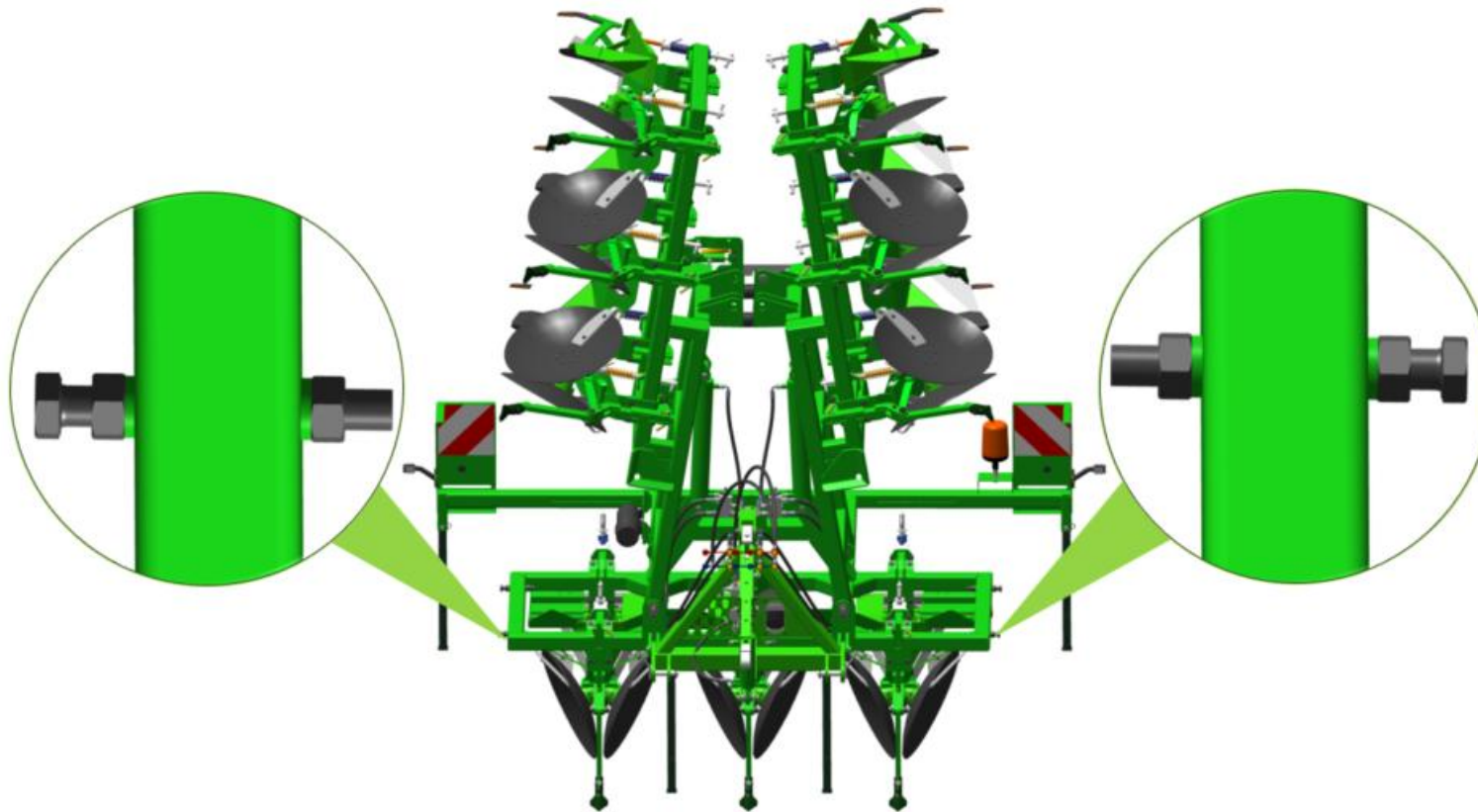

Kombi-Maschinen

Speedridger



ECO-ridger

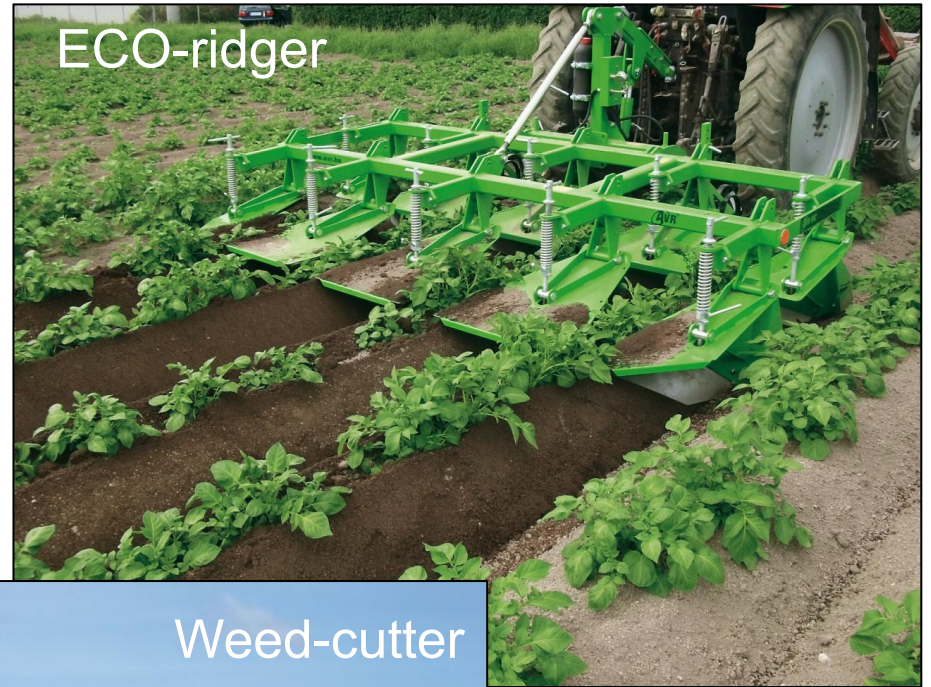

Weed-cutter



Hauptrahmen mit Klemmhalterungen

Variabler Rahmen

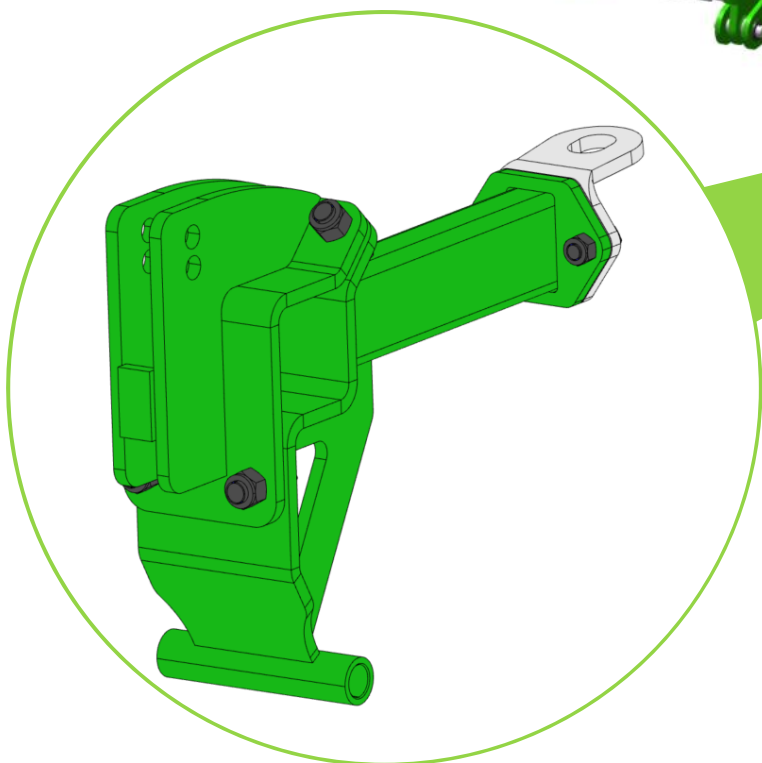
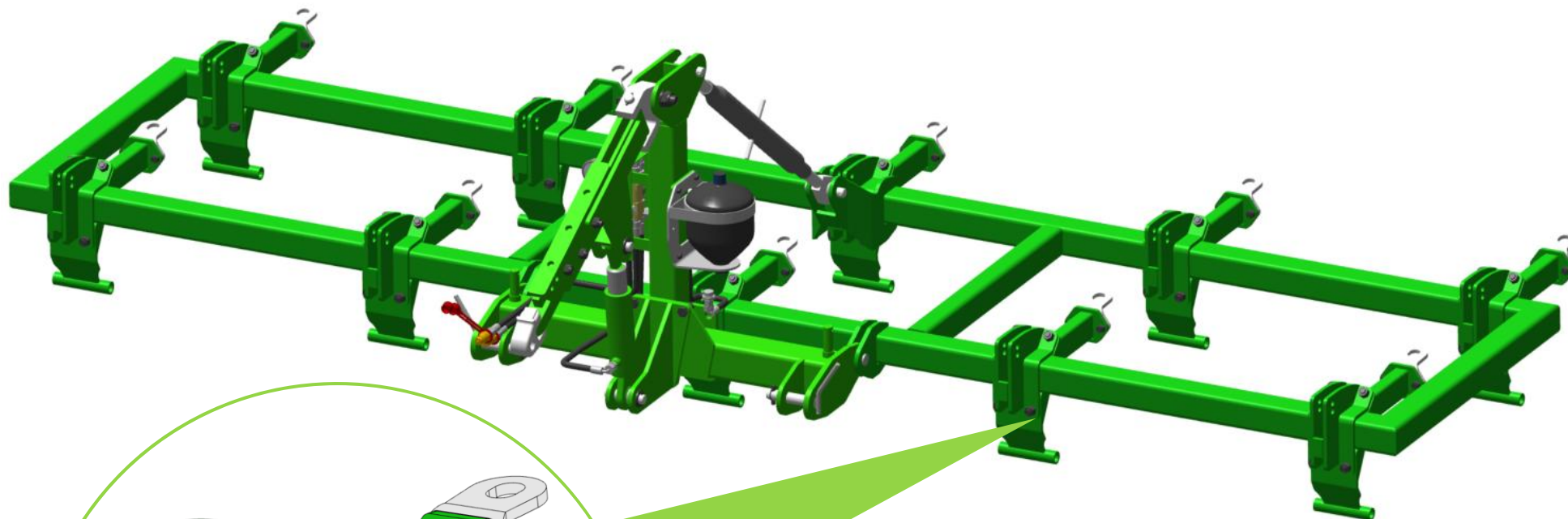

Federbelastete Gewindestangen zur Tiefeneinstellung

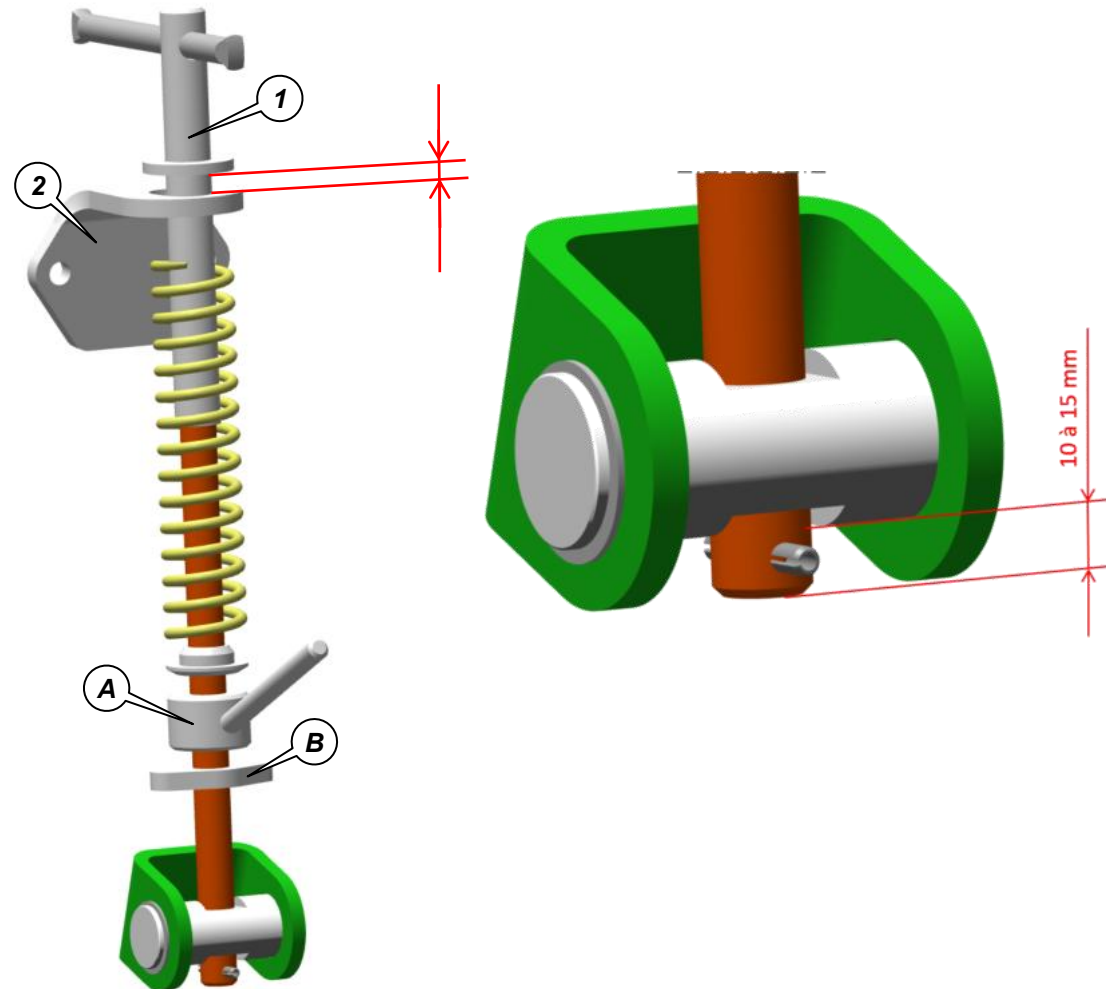

Dammformelemente

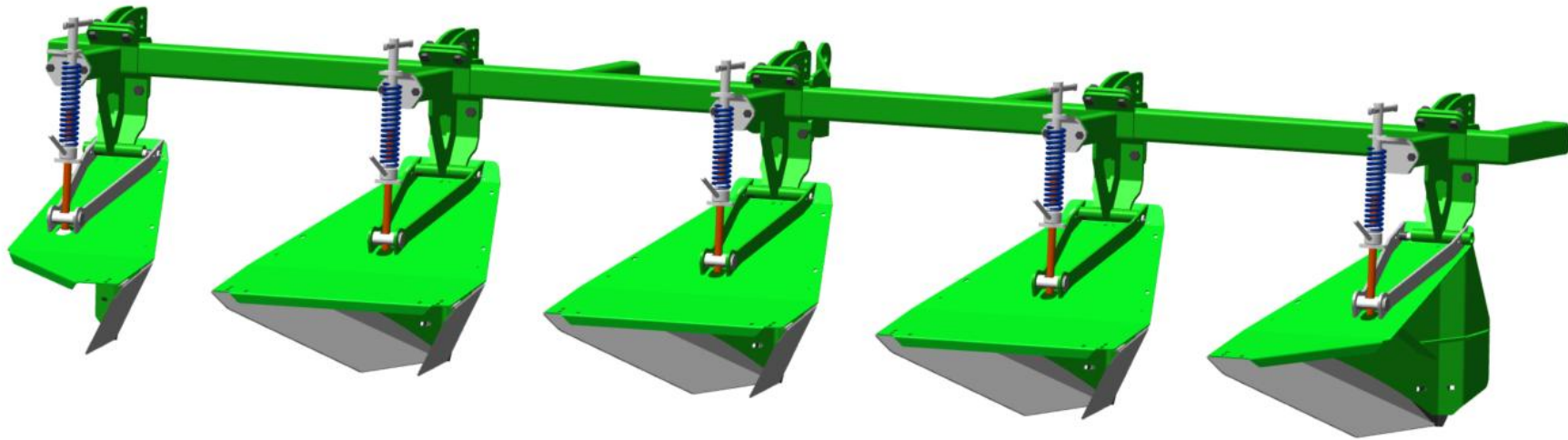

Dammformelement - Detailansicht

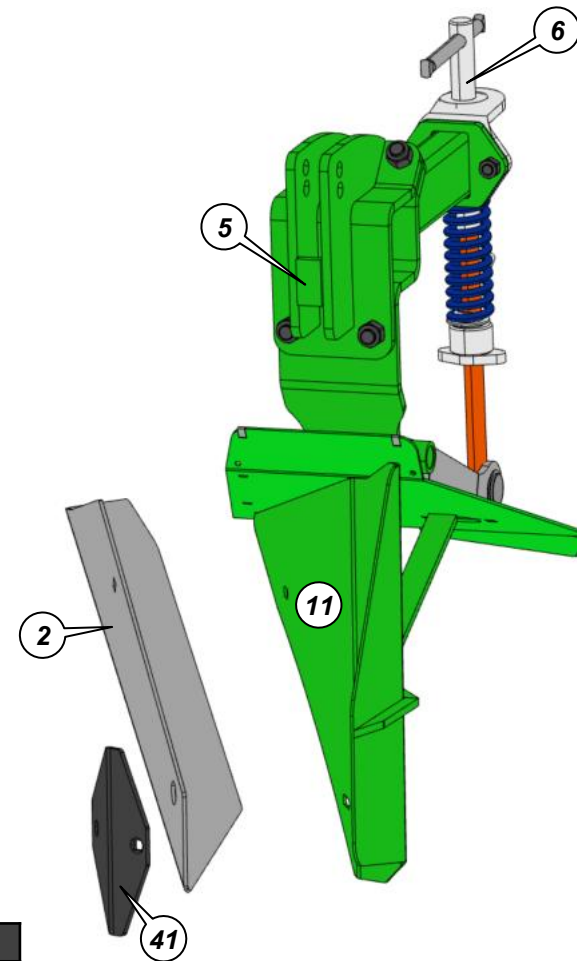
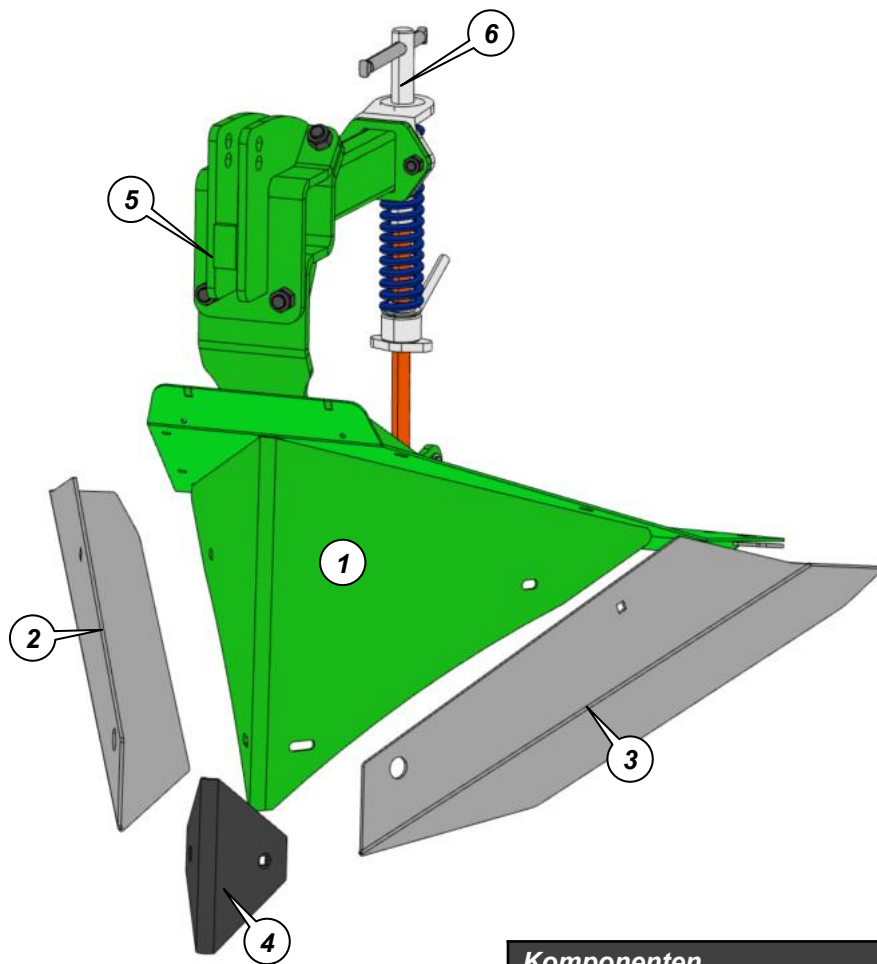

Komponenten	
Nr.	Beschreibung
1	Grundrahmen Häufelement
11	Grundrahmen halbes Häufelement (rechts)
2	Verschleißplatte (links)
3	Verschleißplatte (rechts)
4	Verschleißspitze
41	Verschleißspitze halbes Häufelement
5	Halter
6	Tiefen & Druckeinstellung

Geschlossener Dammformer

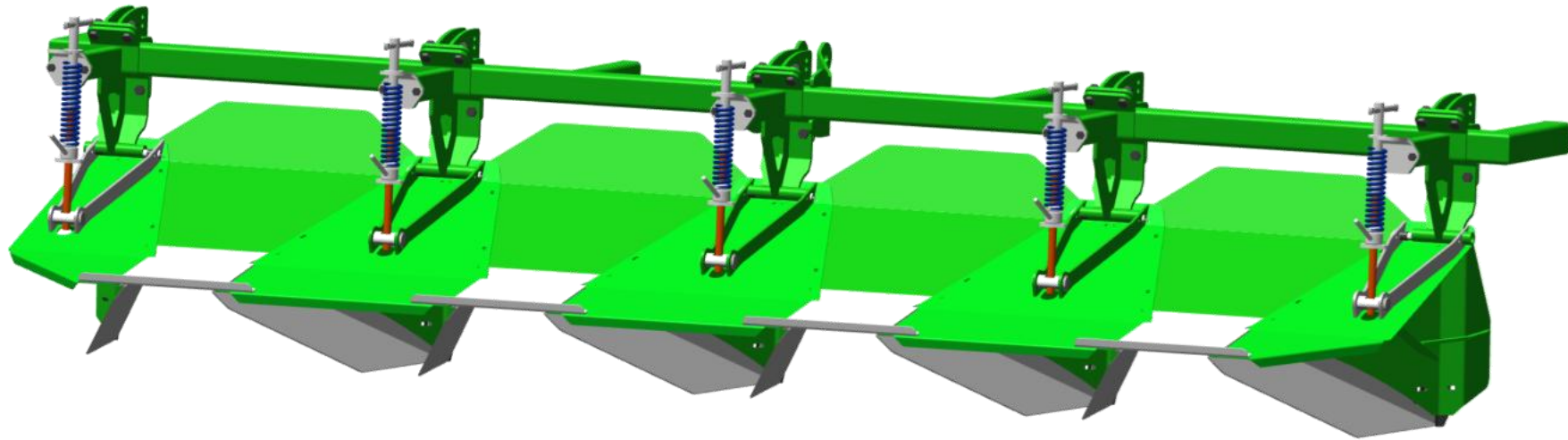

Dammformparameter

Ridge form parameters		
	4x75	4x90
H	28 - 33 cm	28 - 33 cm
h	15 - 23 cm	15 - 25 cm
O	100 cm	110 cm
b default	17.5 cm	22.5 cm
b option	22.5 cm	

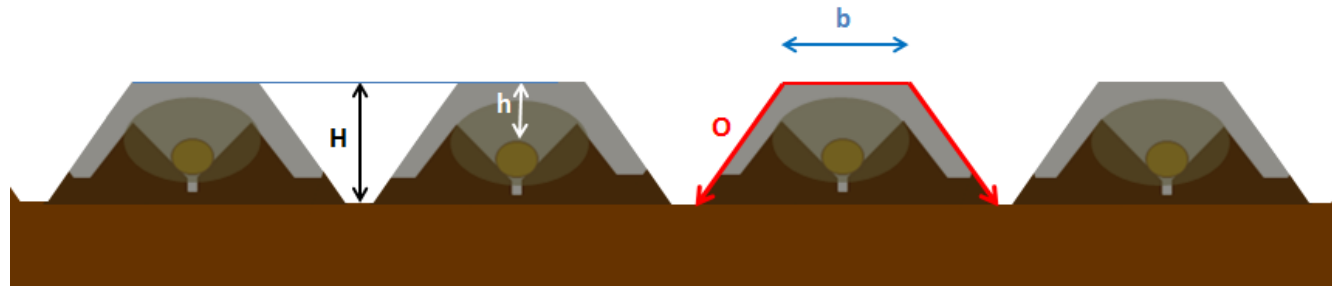

Verschiedene Teile am Dammformer



Tabelle auf der Montagezeichnung [NR-403250](#) mit typischen Abmessungen der Deckplatte/Edelstahlplatte in Abhängigkeit vom Reihenabstand

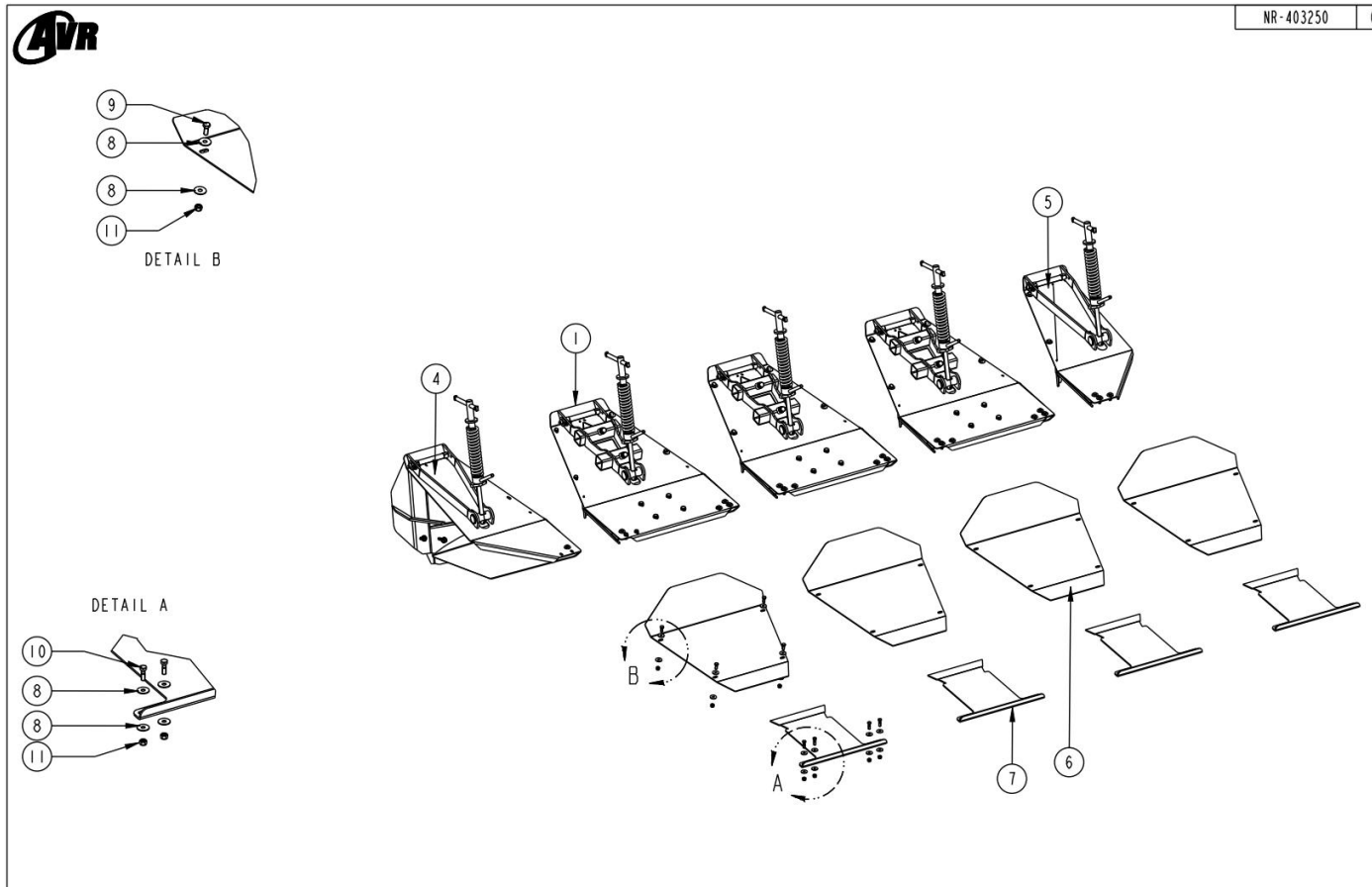
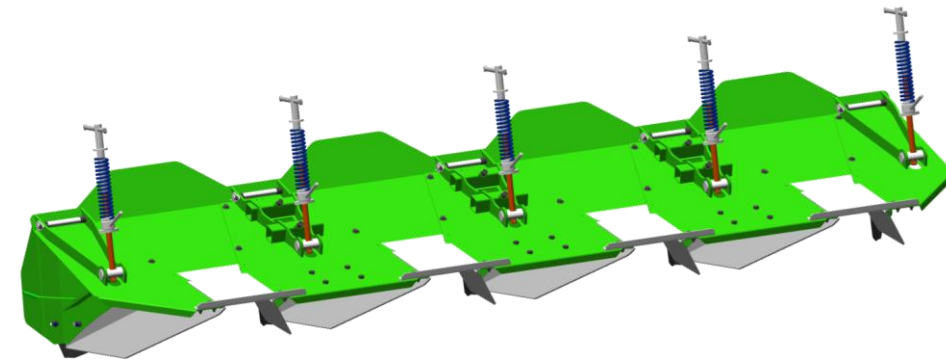

Verschiedene Teile am Dammformer



NR-403250 0

Distance	AVR NR.	A ± 2mm	B ± 5mm
75CM	020167	540	455
75CM WIDE	020169	535	380
90CM	020171	692	510
80CM	NR-110152	590	455
36"	NR-400201	706	512
34"	NR-400206	656	512
85CM	NR-400208	642	510

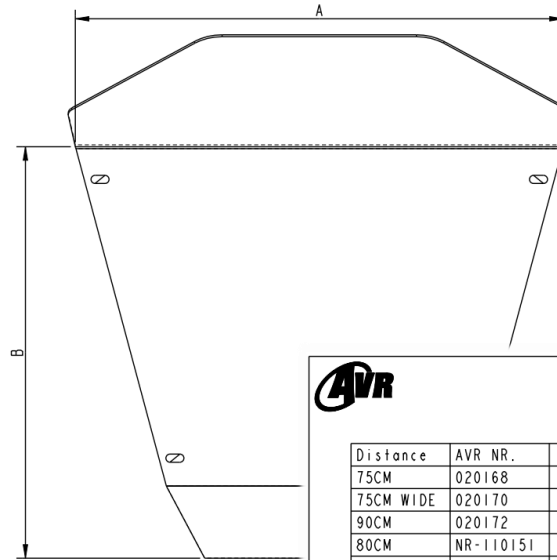

NR-403250 0

Distance	AVR NR.	A	B ± 5mm
75CM	020168	400	391
75CM WIDE	020170	445	395
90CM	020172	470	348
80CM	NR-110151	450	391
36"	NR-400202	485	345
34"	NR-400207	435	345
85CM	NR-400209	420	343

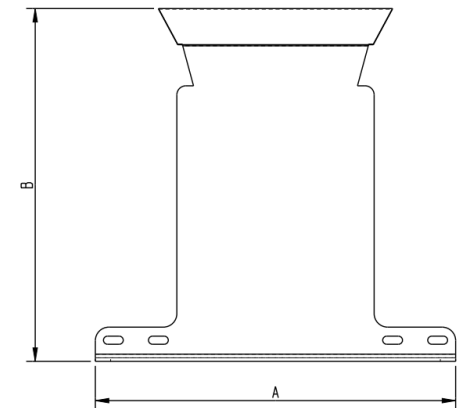

Zudeckscheiben am Speedridger

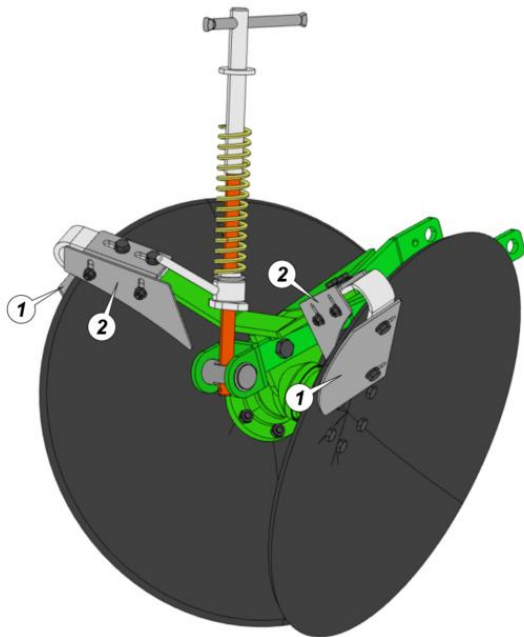
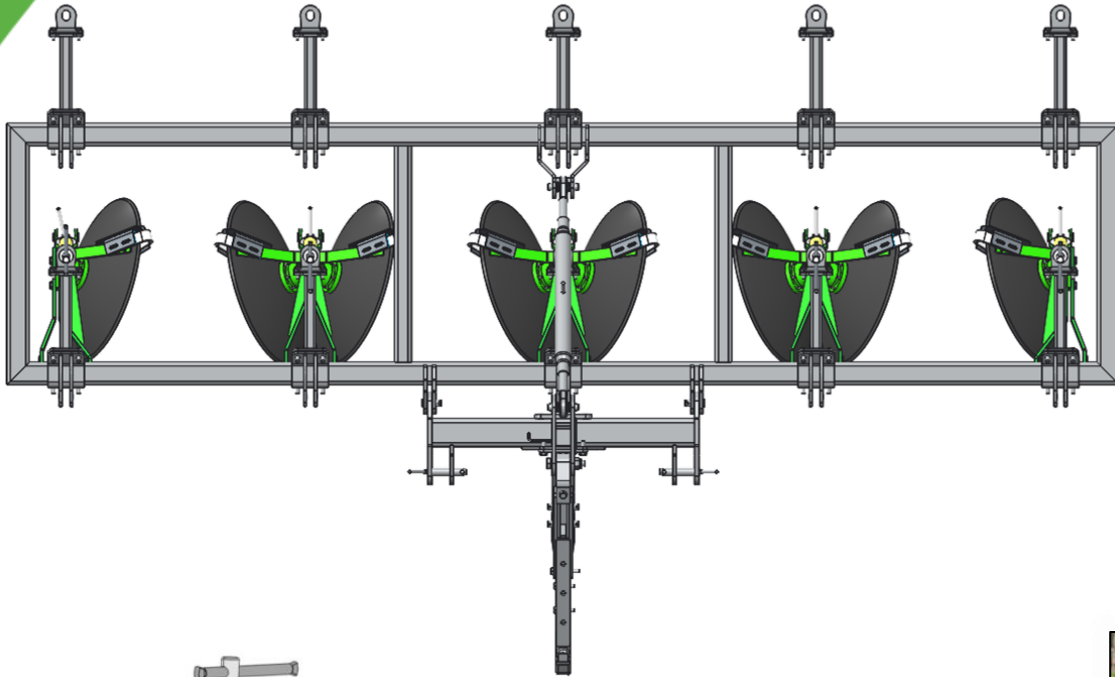

Zudeckscheiben am Speedridger

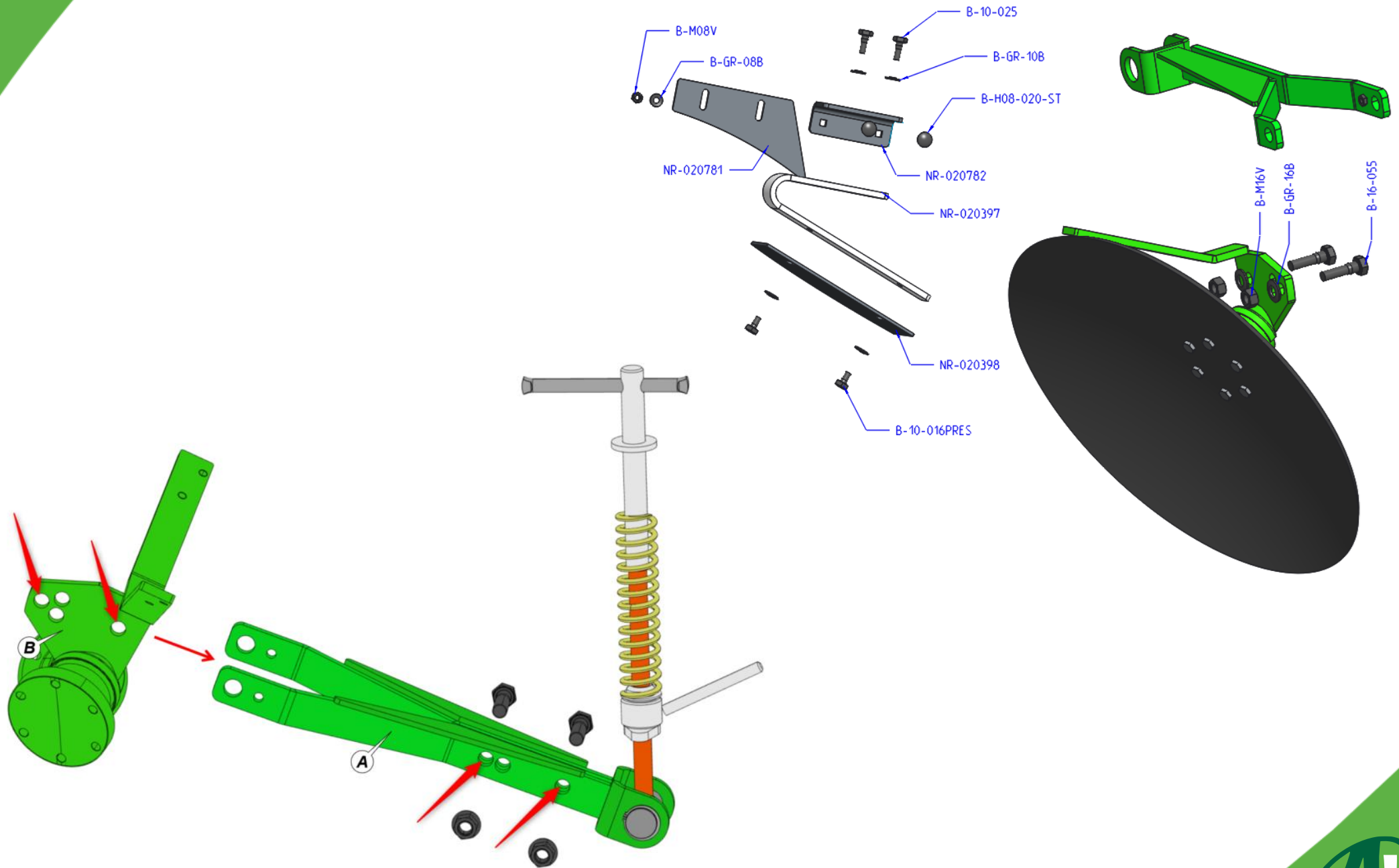

ECO Elemente am ECO-Ridger

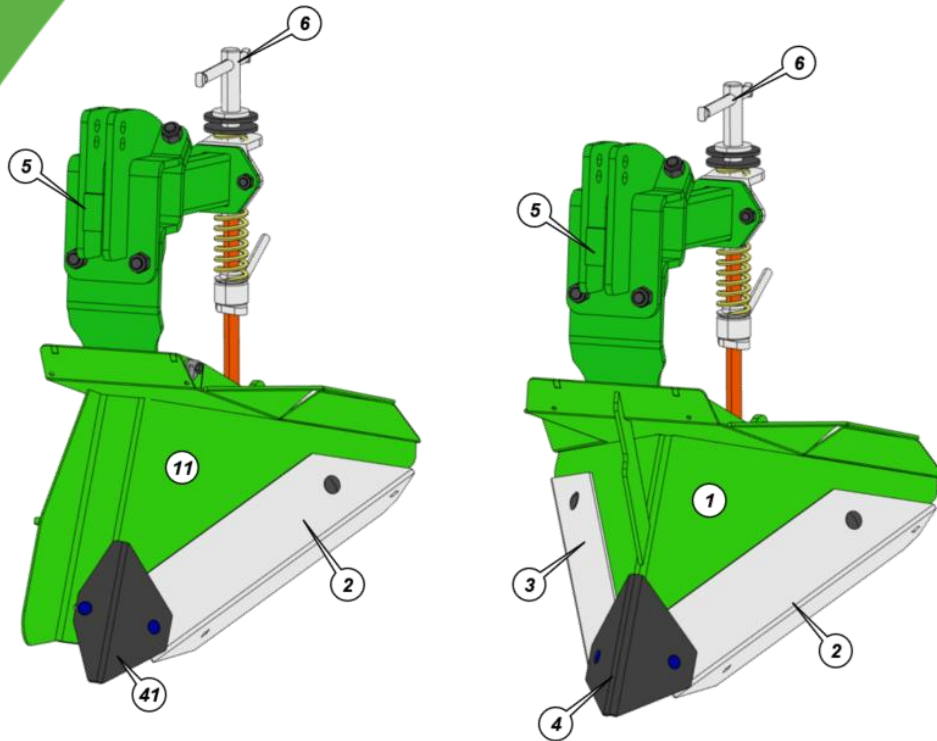

Komponenten	
Nr.	Beschreibung
1	ECO-Element Grundrahmen
11	Grundrahmen halbes ECO-Element (rechts)
2	Verschleißplatte (links)
3	Verschleißplatte (rechts)
4	Verschleißspitze ECO-Element
41	Verschleißspitze halbes ECO-Element
5	Halter
6	Tiefen & Druckeinstellung

Hackelemente & Striegel

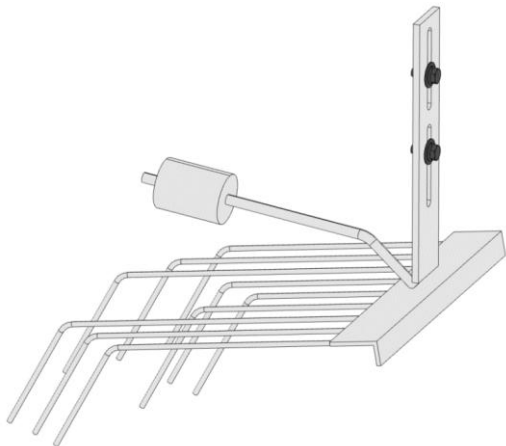
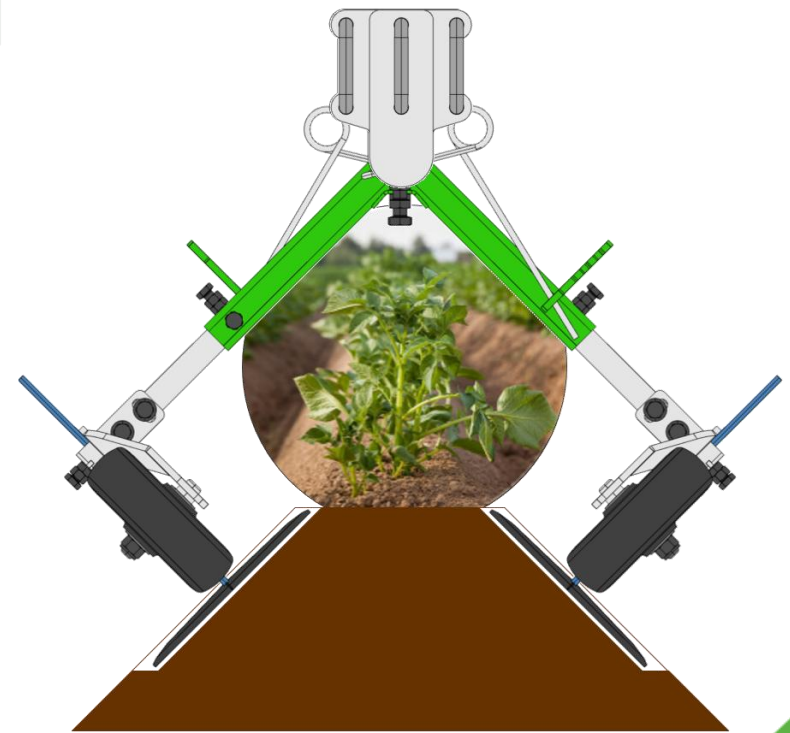
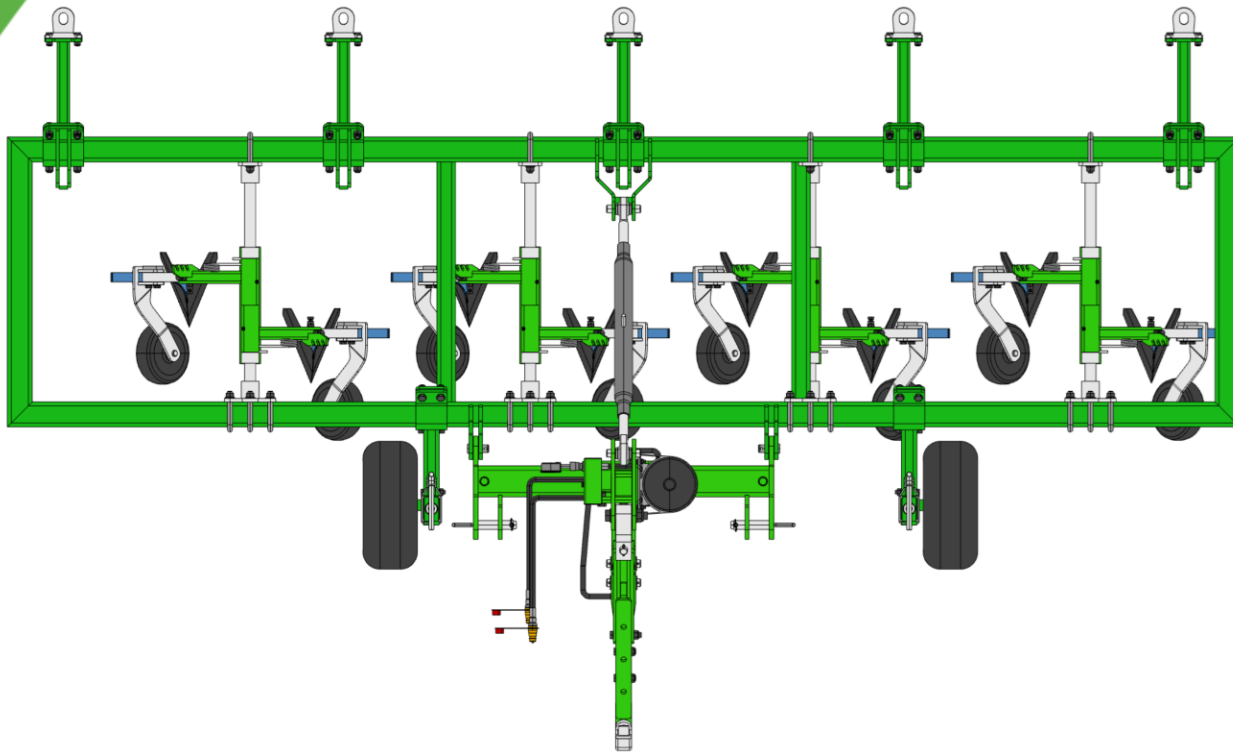

Pflanzenschutz für Möhren

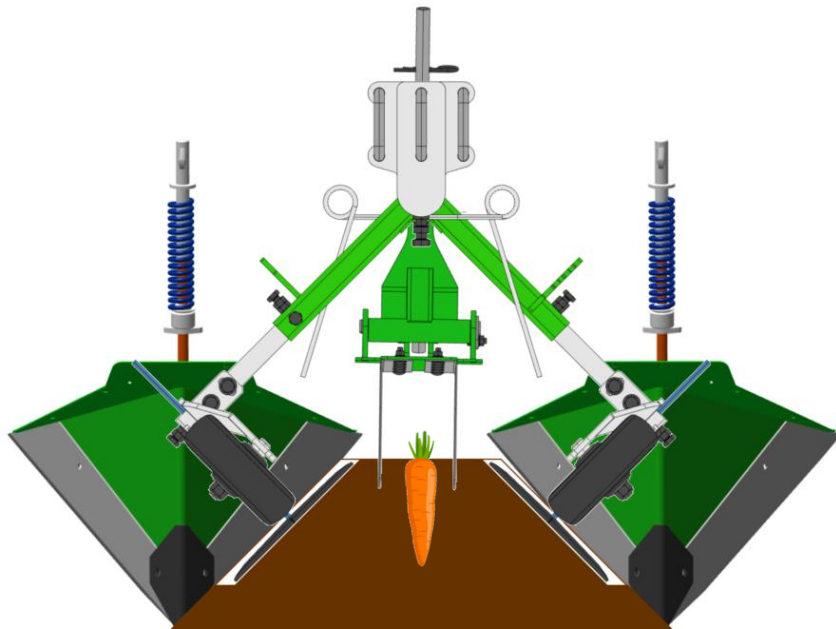
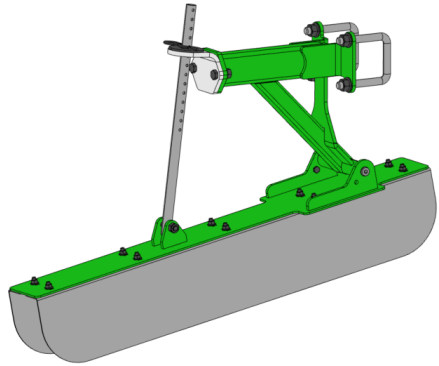

Verschiedene Arten von Tieflockerern - Zinken

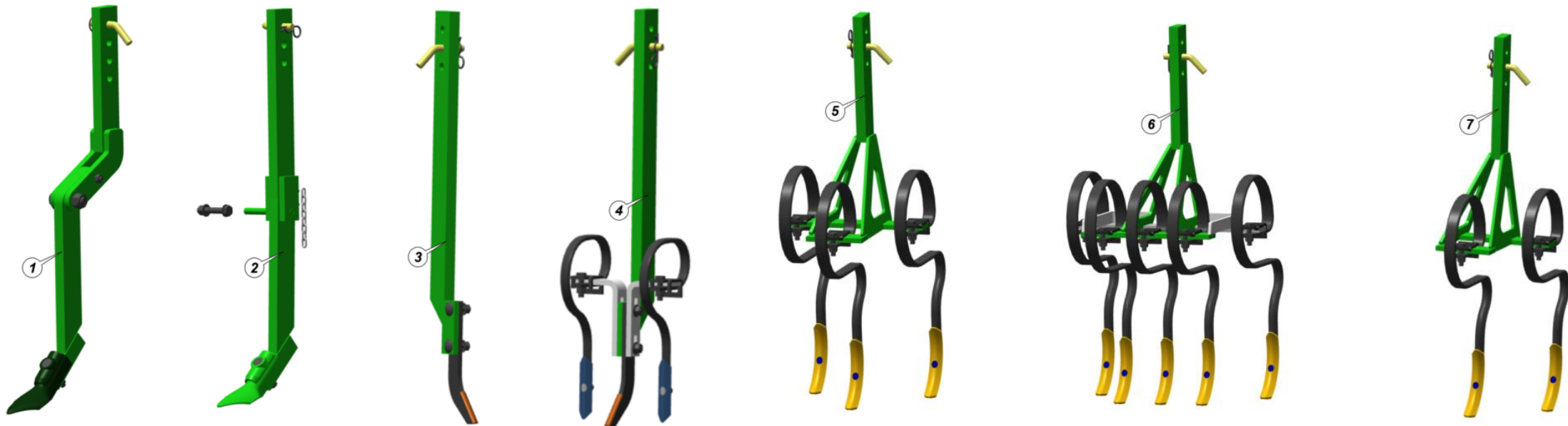

Einstellung der Zinken

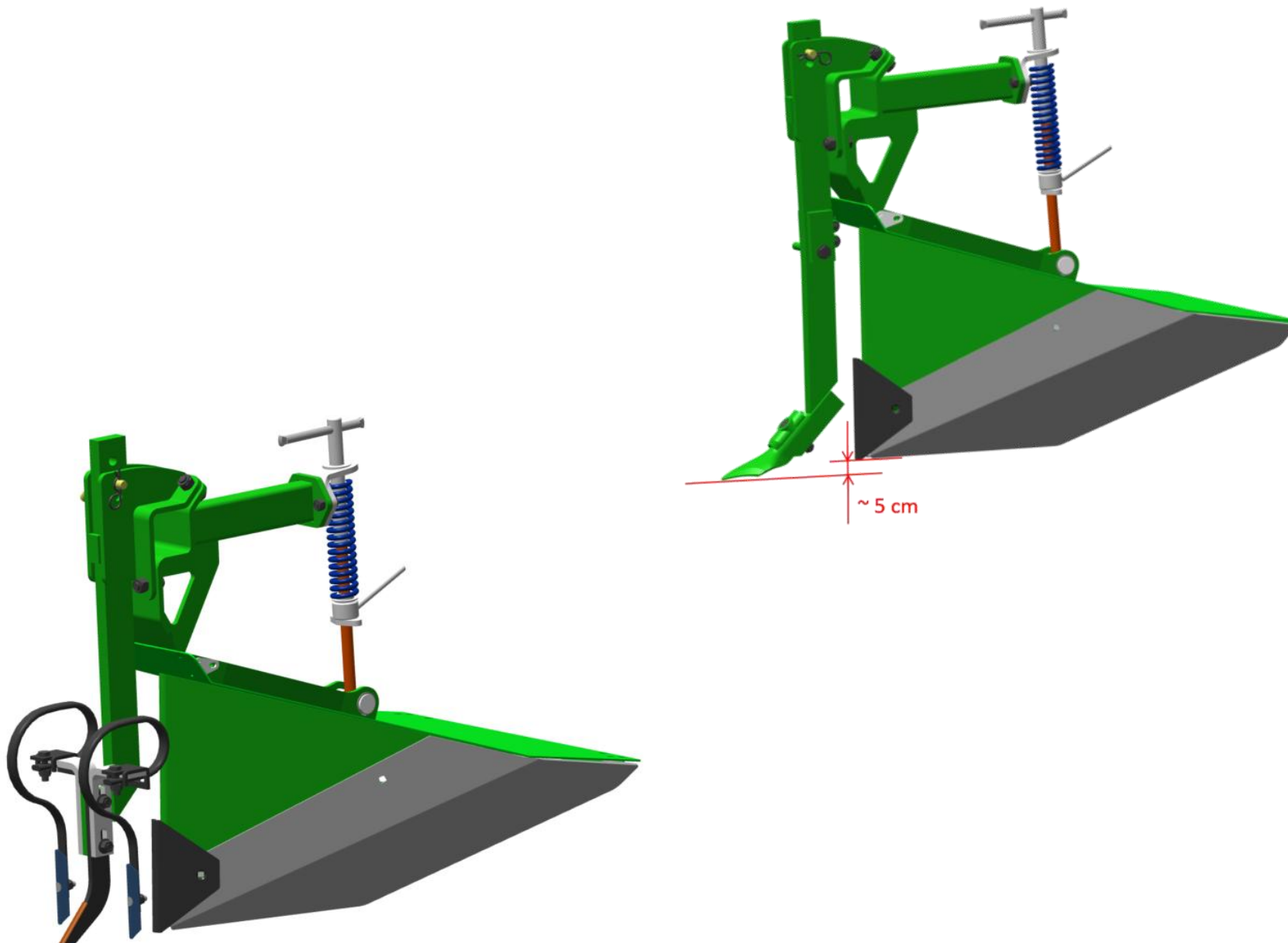

Untergrundlockerer auf dem Ridger



Wenn ein Tiefenlockerer auf ein Hindernis stößt, bricht der Tragarm des Hakenzugs ab. Der Sicherheitsbolzen hat in diesem Fall keine Funktion.



Neues Design mit Sicherheitsbolzen, durch praktische Tests bestätigt

NR-440210-M



NR-440240-M



Zusätzliche Optionen für den Ridger

- Leitski

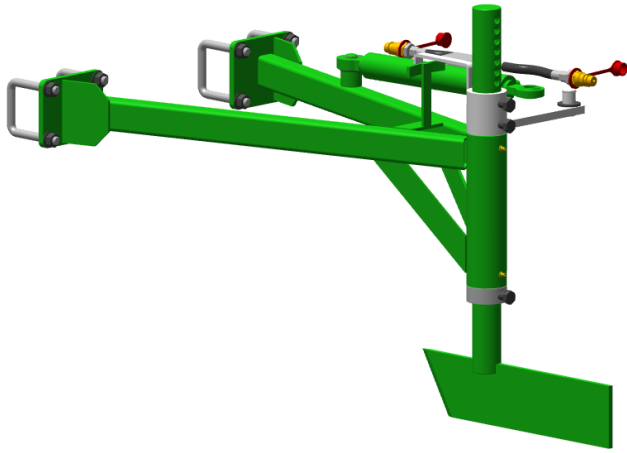

- Hangscheiben

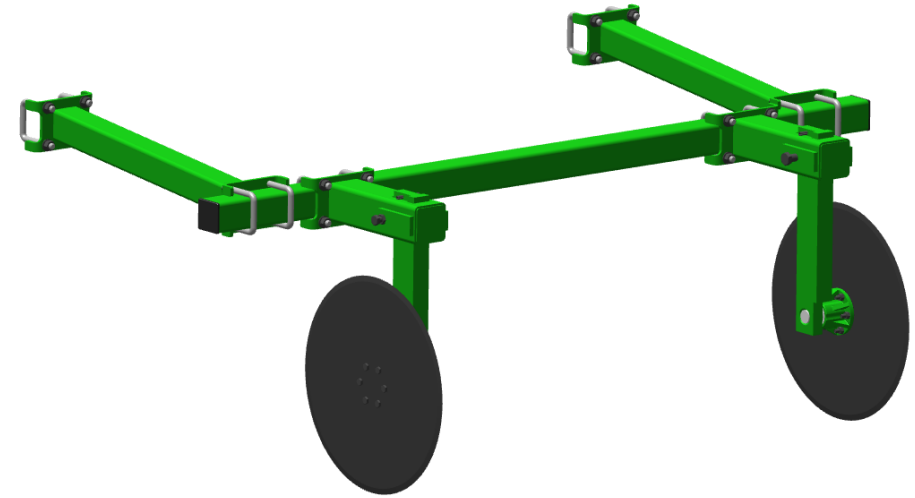

- Lockerungszinken

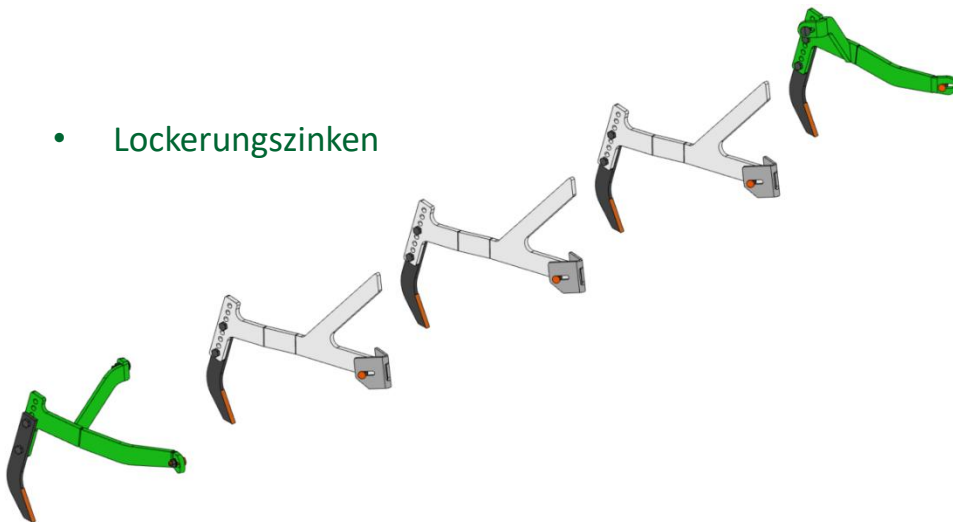

- Fahrgassenräumer

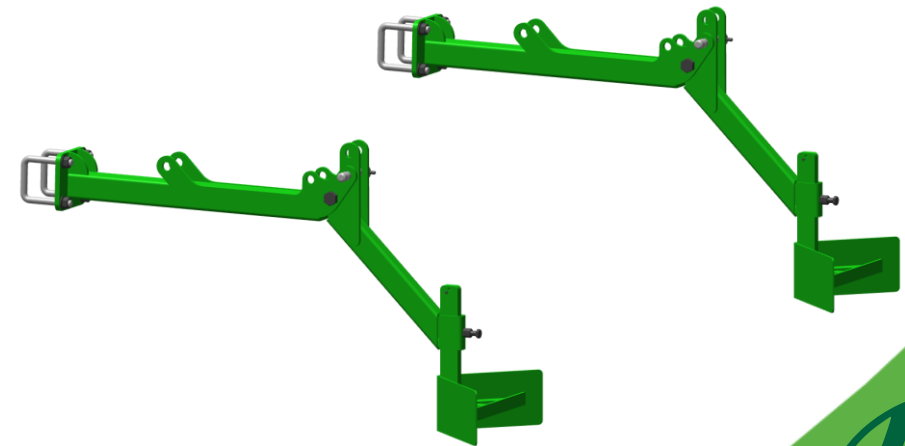

Anti-Erosions Kit

Neuer Erosionsschutzsatz für 4x Ridger (NR-430700)

Erhältlich für 4-reihige Häufelgeräte

Ähnlich wie der Erosionsschutzsatz für die Ceres 200H

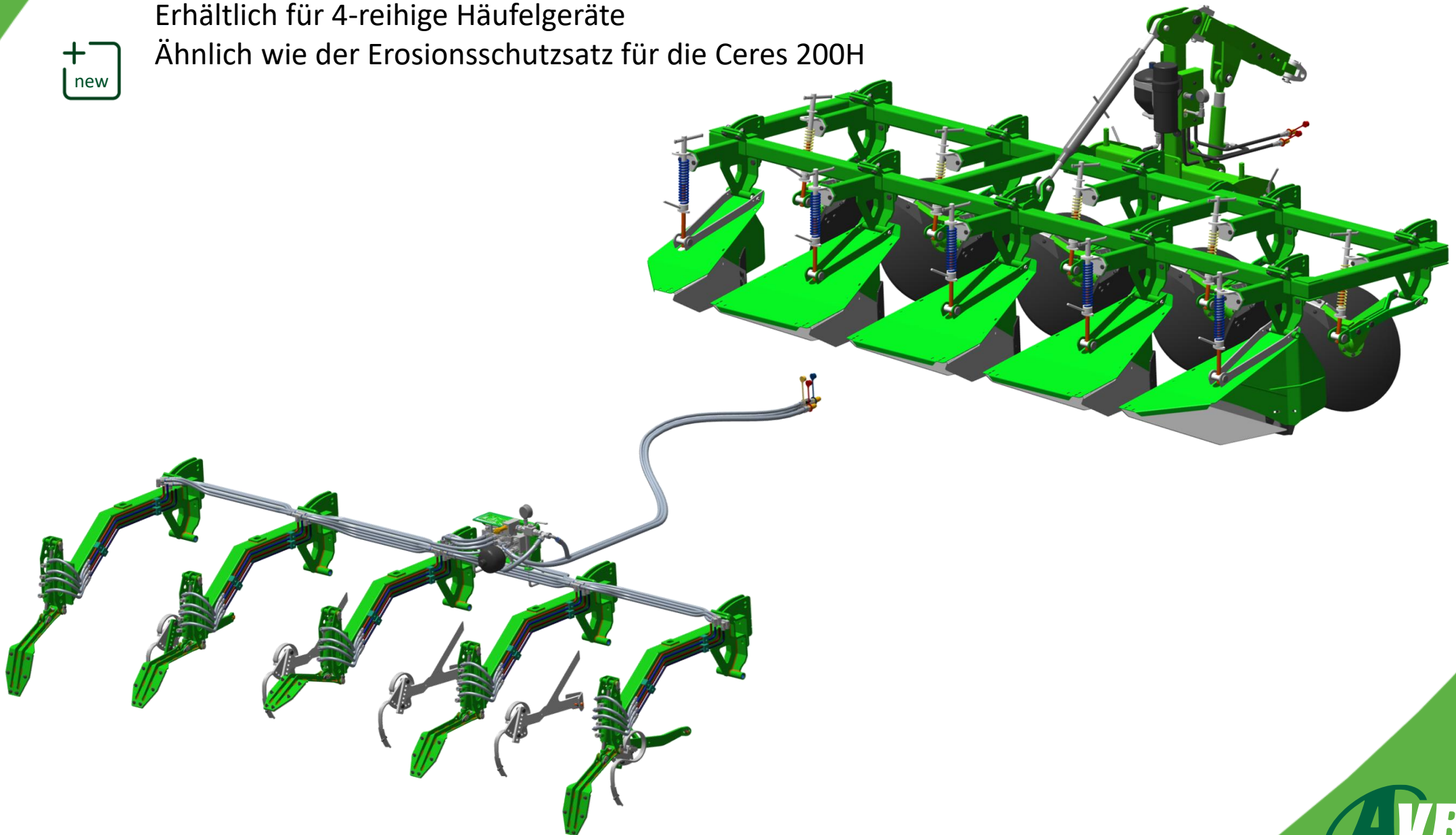

ASI – Seitenschiebe-Autolenkung

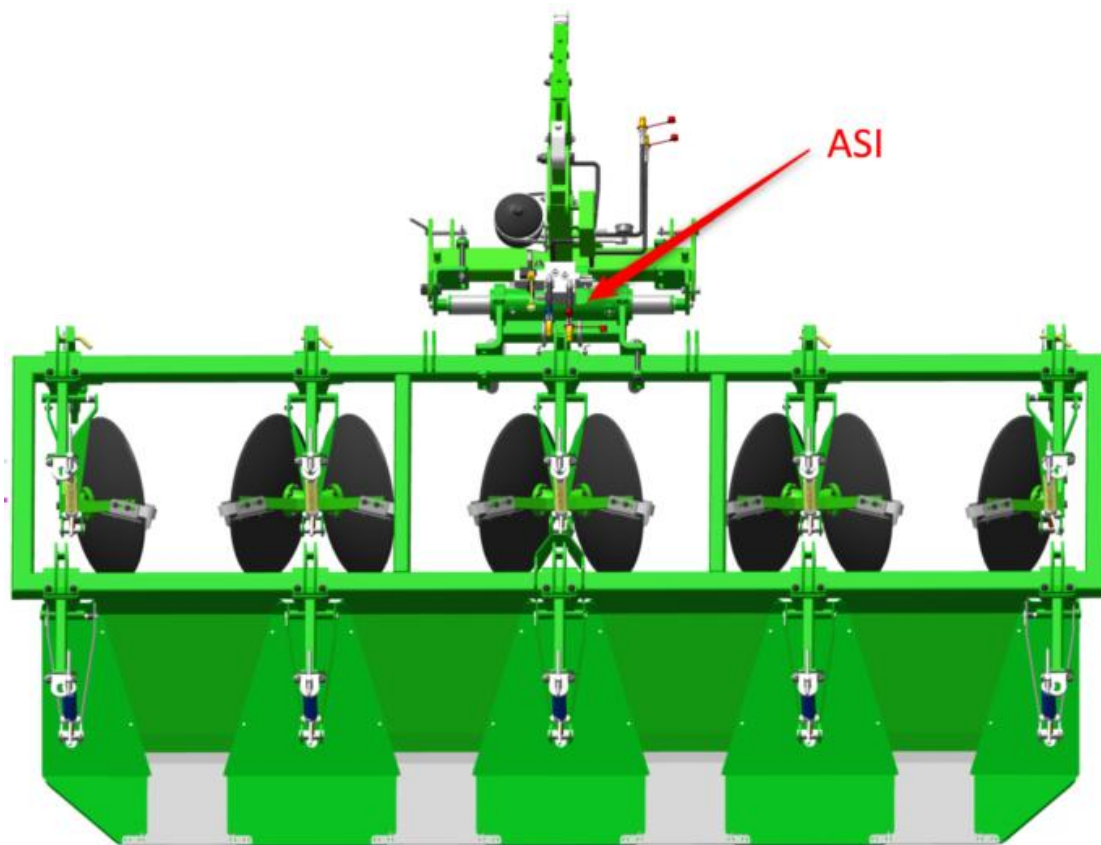
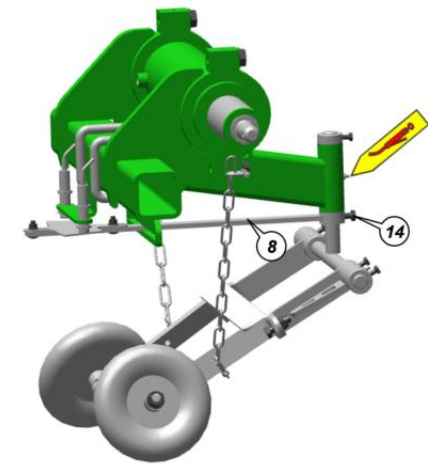
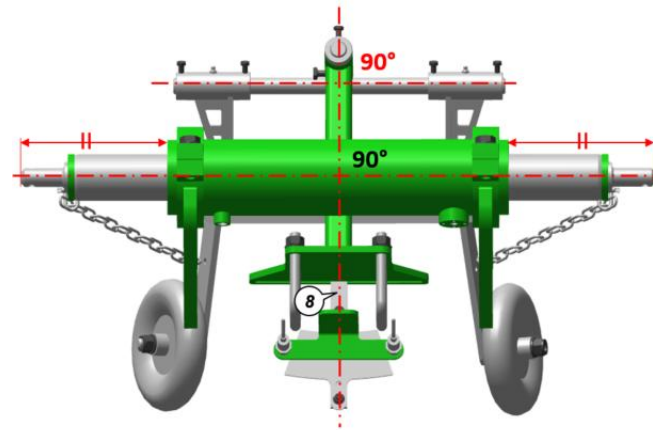

ASI – Seitenschiebe-Autolenkung

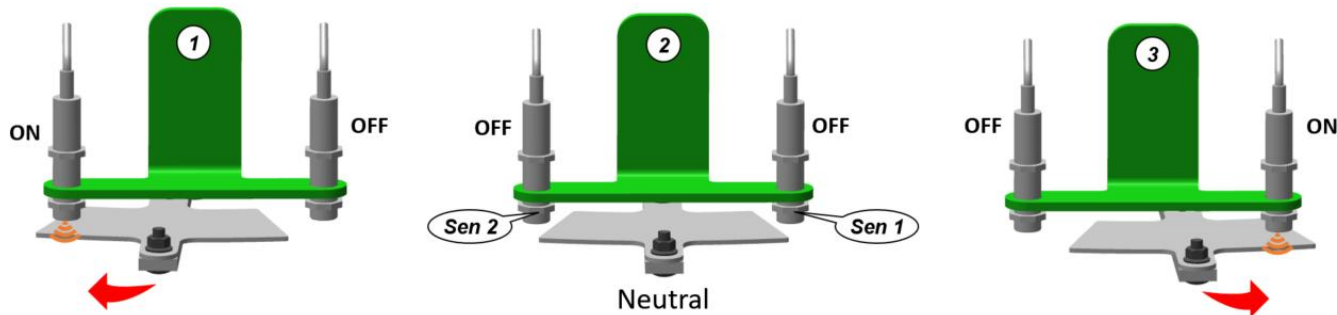
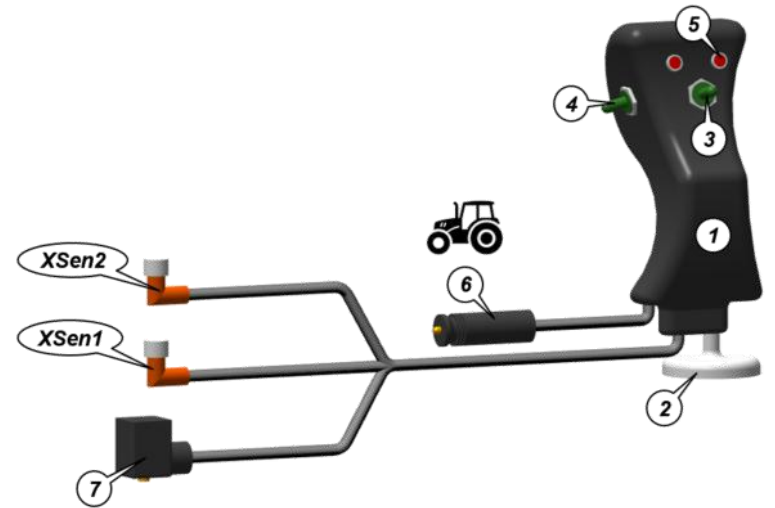
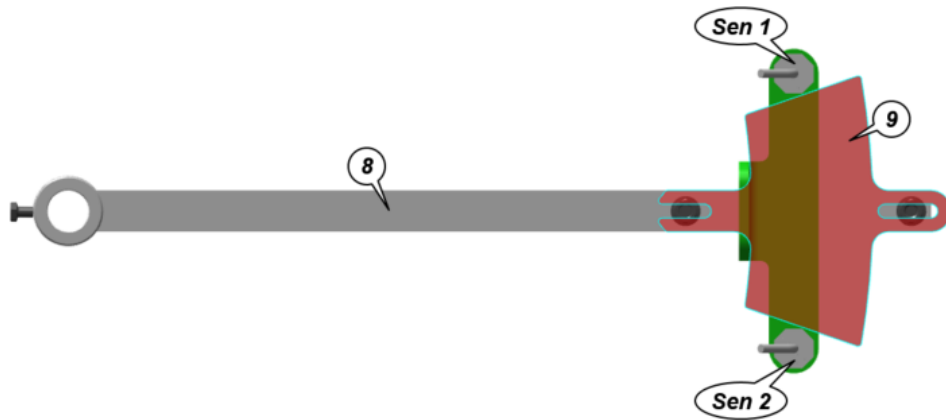
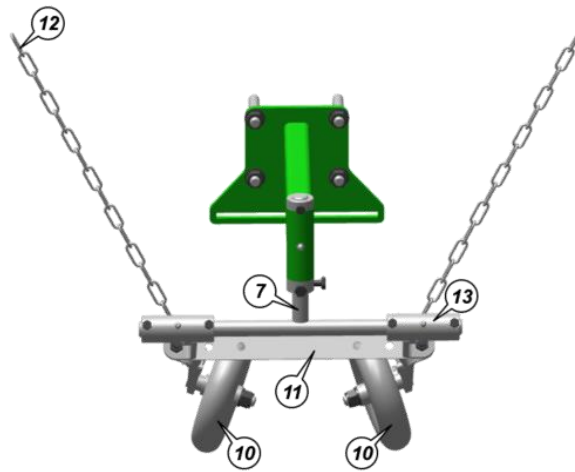
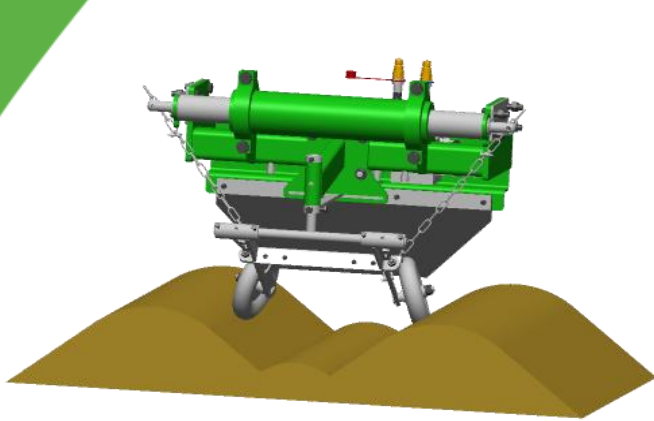

Lenkung



